

PLAT OF SURVEY

LEGAL DESCRIPTION:
A PARCEL OF LAND LOCATED IN THE NORTHERN 1/2 OF THE SOUTHEAST 1/4 AND THE SOUTHEAST 1/4 OF THE NORTHEAST 1/4 OF SECTION 9 IN TOWNSHIP 1 NORTH, RANGE 17 EAST, IN THE TOWN OF LINN, WALWORTH COUNTY, WISCONSIN.

MORE PARTICULARLY DESCRIBED AS:







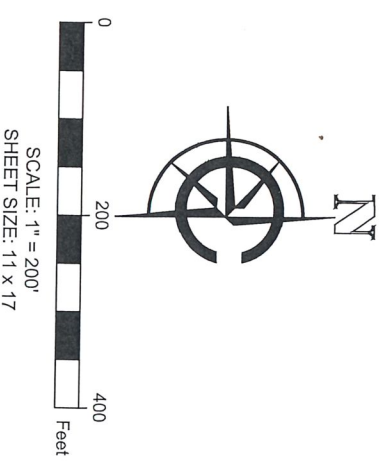
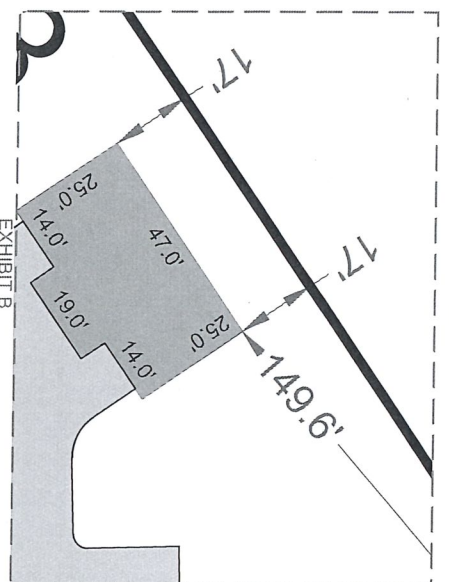
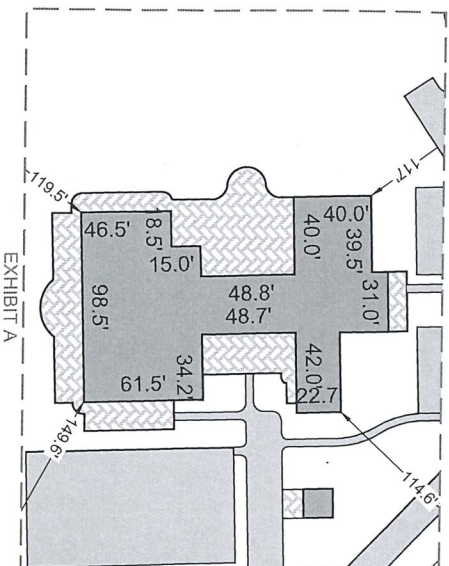
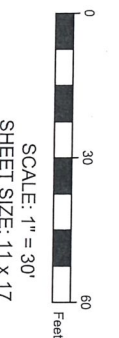



LOT 3 OF CSM 5101 AS RECORDED IN DOCUMENT NO. 1078781 PER THE WALWORTH COUNTY REGISTER OF DEEDS.

ATTENTION:

"ANY LAND BELOW THE ORDINARY HIGH WATER MARK OF A LAKE OR NAVIGABLE STREAM IS SUBJECT TO THE PUBLIC TRUST IN NAVIGABLE WATERS THAT IS ESTABLISHED UNDER ARTICLE IX, SECTION 1, OF THE STATE CONSTITUTION".



LEGEND

| | | | |
|---|-------------------|---|---|
|  | PROPOSED BUILDING |  | FOUND IRON ROD |
|  | PROPOSED ASPHALT |  | SET 1" I.D. IRON PIPE 18", 1.13#/ L.F. |
|  | PROPOSED BRICK |  | SET MAGNALL |
|  | XC |  | EXISTING FENCE |
|  | |  | SHORELINE |

| LOT LINE TABLE | | |
|----------------|-------------|---------------|
| LINE NUMBER | LENGTH (FT) | DIRECTION |
| L1 | 50.00 | N47° 29' 45"W |
| L2 | 126.00 | N46° 09' 36"W |
| L3 | 114.15 | N40° 42' 34"W |
| L4 | 136.25 | N30° 53' 27"E |
| L5 | 70.97 | N30° 53' 27"E |
| L6 | 59.48 | S75° 11' 55"W |
| L7 | 53.02 | S25° 53' 39"E |
| L16 | 255.64 | N28° 27' 20"E |
| L17 | 92.40 | N00° 12' 15"E |
| L18 | 11.31 | N42° 30' 15"E |

| LOT CURVE TABLE | | | | | | | |
|-----------------|-------------|-------------|------------|--------------|---------------|---------------|---------------|
| CURVE NUMBER | LENGTH (FT) | RADIUS (FT) | Δ | CHORD LENGTH | CHORD BEARING | TAN IN | TAN OUT |
| C1 | 455.44 | 737.86 | 035°21'57" | 448.25 | S76° 20' 50"W | S58° 39' 52"W | N85° 58' 11"W |
| C2 | 173.59 | 1114.31 | 008°55'33" | 173.42 | S89° 34' 02"W | N85° 58' 11"W | S85° 06' 16"W |
| C3 | 70.66 ± | 1114.31 | 003°38'00" | 70.65 ± | S83° 17' 16"W | S85° 06' 16"W | S81° 28' 16"W |
| C4 | 479.73 | 787.89 | 034°53'11" | 472.36 | S76° 31' 26"W | S59° 04' 51"W | N86° 01' 58"W |
| C5 | 147.65 | 1179.81 | 007°10'14" | 147.56 | N89° 37' 05"W | N86° 01' 58"W | S86° 47' 48"W |
| C6 | 85.74 ± | 1179.81 | 004°09'50" | 85.72 ± | S84° 42' 53"W | S86° 47' 48"W | S82° 37' 58"W |
| C7 | 73.96 | 150.00 | 028°15'05" | 73.21 | N14° 19' 47"E | N28° 27' 20"E | N0° 12' 15"E |
| C8 | 36.91 | 50.00 | 042°18'00" | 36.08 | N21° 21' 15"E | N0° 12' 15"E | N52° 30' 33"E |

"HEREBY CERTIFY THAT I HAVE SURVEYED THE ABOVE DESCRIBED PROPERTY AND THE MAP IS A TRUE AND CORRECT REPRESENTATION OF ITS EXTERIOR BOUNDARIES AND SHOWS THE SIZE AND LOCATION OF ALL VISIBLE STRUCTURES, APPARENT EASEMENTS AND ENCROACHMENTS, IF ANY.

PAUL H VAN HENKELUM, PLS #1931

DATE 1/2

SURVEY ORDERED BY:
KURT STRICKER

PROPERTY ADDRESS:
LACKEY LANE
TOWN OF LINN, WI 53147

FIELD WORK COMPLETED ON:
MARCH 03, 2022

FIELD CREW CHIEF:
MIKE MELENZIO

SURVEYOR:
PAUL H. VAN HENKELUM, PLS
CARDINAL ENGINEERING LLC

IS OF BEARING:
THE WISCONSIN STATE PLANE COORDINATE SYSTEM,
NAD-83, SOUTH ZONE.
THE NORTH LOT LINE OF LOT 3 CSM 5101 IS ASSUMED TO BEAR
S55°43'04"W.

The seal of the University of Wisconsin is a circular emblem. It features a central five-pointed star. Inside the star, the text "PAUL H. VAN HEKELUM" is written in a serif font, with "S-1931" below it. The outer ring of the seal contains the words "UNIVERSITY OF WISCONSIN" in a serif font, with "LAKE GENEVA, WI" at the bottom. The seal is rendered in a dark blue or black color.

CARDINAL
PLAN | SURVEY | ENGINEER
1200 LA SALLE ST.
LAKE GENEVA, WI 53147
262-757-8776
PLANSURVEYENGINEER.COM

DATE: 08 / 28 / 2023 JOB No. 22302
SHEET 1 OF 1 SEM

G:\Shared drives\Cardinal Office\Projects\22302-(S) Lackey Lane Development\DWG\BASE\22302P CLUBHOUSE.dwg

PLOTTED: 8/28/2023 8:07:54 AM